



ESCAPE

Palmer Johnson 120

Extensive refit during 2020 with complete super structure and hull repainted with awlgrip metallic paint, new teak decks, enlarged swim platform, new electronics, new interior decor, new audio visual equipment etc.

YEAR	:	2005 - 2020
L.O.A.	:	36.6 m
BEAM	:	7.12 m
DRAFT	:	1.98 m
DISPLACEMENT	:	Gross tonnage 197
FUEL	:	26.700 litres
WATER	:	3.500 litres
ENGINES	:	2 x 2735 hp MTU 12V 4000 M90
HOURS	:	5293 (March 2021)
Max speed	:	26 knots
Cruise economic	:	@ 15 knots, 1300 rev and 125 l/h /engine
FLAG	:	Netherlands
LOCATION	:	Mainland Spain
PRICE	:	€4.950.000 + Vat if applicable

All particulars are believed to be correct, but not guaranteed.

LAYOUT:

Accommodation for 8 guests and 5/6 crew.
3 double bed cabins and one TV room foyer cabin for 2
All cabins ensuite bathroom.
Crew cabins; 1 captain and 2 twin cabins

NAVIGATION:

Electronics new 2020
2 x 24" displays
2 x 21" displays
Radar open array antenna Furuno X Band
Radar antenna closed dome
GPS antenna
Plotter Navisailor 4000 Sperry Marine
Autopilot Navipilot 4000
Magnetic compass Ritchie
Rudder angle indicators
Log and depth Raymarine
AIS
PC x 2
CCTV with cameras in engine room, 2 forward and 2 aft looking
BNWAS Furuno – navigational watch system with motion detection
Flir night vision cameras x 2 with 16" touch screen display
3 domes on arch
Horn Kahlenberg
Satelite telephone Fleet 55
Trim tabs Humphree
Electronic engine controls

All particulars are believed to be correct, but not guaranteed.

EQUIPMENT:

Zero speed stabilizers fin Humphree electric (new 2020)
All exterior new paint done 2020
Swim platform enlarged 2020
Teak deck new 2020
Interior decor new 2020
2 generators 54KW John Deere/Kilopak with hours 9129 and 13100
50HZ system with 3 phase and single phase voltage
Selco power management system for seamless gen to shore switchover
Converter Asea 72KW 3 phase
Air conditioning Cruisair throughout
2 anchor windlass Maxwell 4000
Anchor chain 2 x 100m 16 mm and 2 anchors
Hydraulic pasarelle
Hydraulic emergency steering system
Electro hydraulic power assisted steering system
Shore power connection with automatic battery chargers
Aft deck large sun cover
Aft garage with electro hydraulic opening
Bow garage with electro hydraulic opening

AUDIO VISUAL:

Entertainment system Crestron
Satelite TV antenna KVH G60
Flat screen TV 55" 4K in saloon
Audio sound bar and speakers in saloon
Blue Ray player
Play station Sony in saloon
Flat screen TV 48" 4K in main cabin
Audio sound bar and speakers in saloon
Flat screen TV 48" 4K in lower deck TV room convertible to guest cabin
Play station Sony in lower deck TV room convertible to guest cabin
Flat screen TV 28" 4K in Vip cabins, crew mess and captains cabin
Projector Epson HD 3D with 6 feet x 3,75 feet screen on flybridge
Amplifier Marantz 17amp
Shuffle PC media server
Wifi
Apple airplay
Apple iPad with custom A/V control app

All particulars are believed to be correct, but not guaranteed.

DOMESTIC:

All galley furniture in s.s. finish and Crew mess sofa and table

Fridge x 2 freezer x 4 drawers

Oven

Ceramic hob

Micro wave oven

Double sink

Dishwasher

Washing machine

Drier

Washing machine drier

Fridge in saloon and flybridge

Ice maker

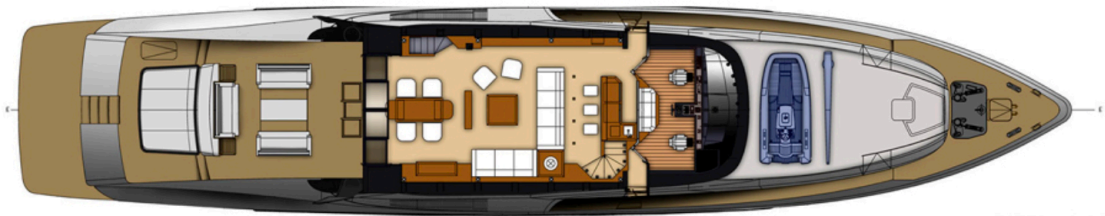
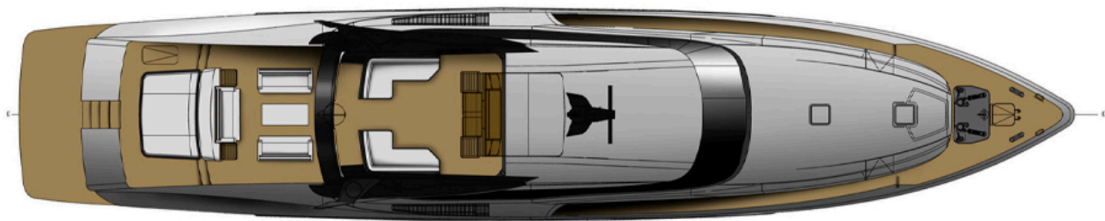

All particulars are believed to be correct, but not guaranteed.